

# SUNTOUR

## SF10-CR8V-V2-P-MLO-26"-50

Date	2010.1.13	Version	1
Amended			

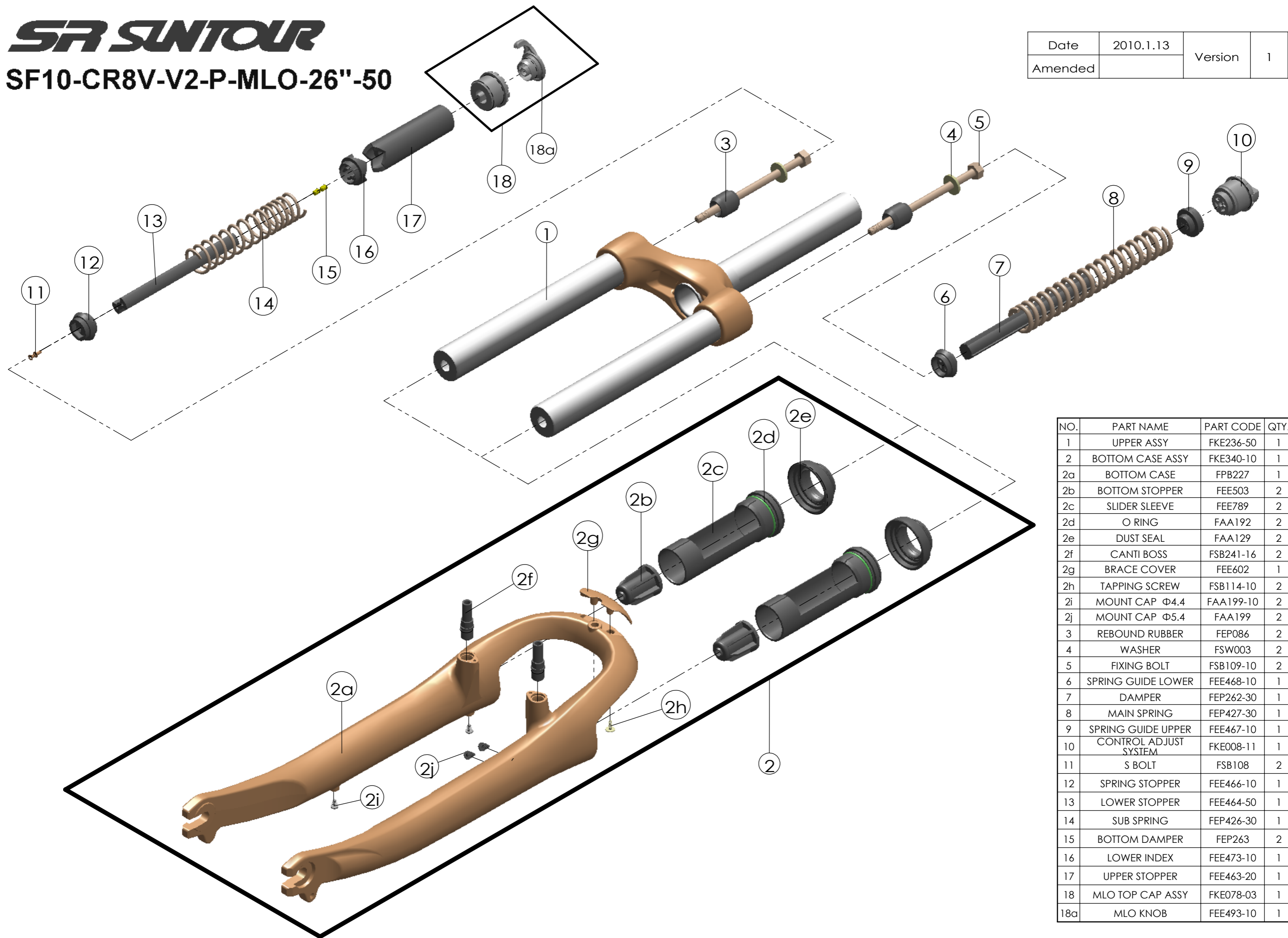

NO.	PART NAME	PART CODE	QTY.
1	UPPER ASSY	FKE236-50	1
2	BOTTOM CASE ASSY	FKE340-10	1
2a	BOTTOM CASE	FPB227	1
2b	BOTTOM STOPPER	FEE503	2
2c	SLIDER SLEEVE	FEE789	2
2d	O RING	FAA192	2
2e	DUST SEAL	FAA129	2
2f	CANTI BOSS	FSB241-16	2
2g	BRACE COVER	FEE602	1
2h	TAPPING SCREW	FSB114-10	2
2i	MOUNT CAP $\Phi 4.4$	FAA199-10	2
2j	MOUNT CAP $\Phi 5.4$	FAA199	2
3	REBOUND RUBBER	FEP086	2
4	WASHER	FSW003	2
5	FIXING BOLT	FSB109-10	2
6	SPRING GUIDE LOWER	FEE468-10	1
7	DAMPER	FEP262-30	1
8	MAIN SPRING	FEP427-30	1
9	SPRING GUIDE UPPER	FEE467-10	1
10	CONTROL ADJUST SYSTEM	FKE008-11	1
11	S BOLT	FSB108	2
12	SPRING STOPPER	FEE466-10	1
13	LOWER STOPPER	FEE464-50	1
14	SUB SPRING	FEP426-30	1
15	BOTTOM DAMPER	FEP263	2
16	LOWER INDEX	FEE473-10	1
17	UPPER STOPPER	FEE463-20	1
18	MLO TOP CAP ASSY	FKE078-03	1
18a	MLO KNOB	FEE493-10	1