

SUNTOUR

SF11-NEX4610-V2-P-HLO

-700C-50,63

| | | | |
|---------|-----------|---------|---|
| Date | 2010.2.10 | Version | 1 |
| Amended | | | |

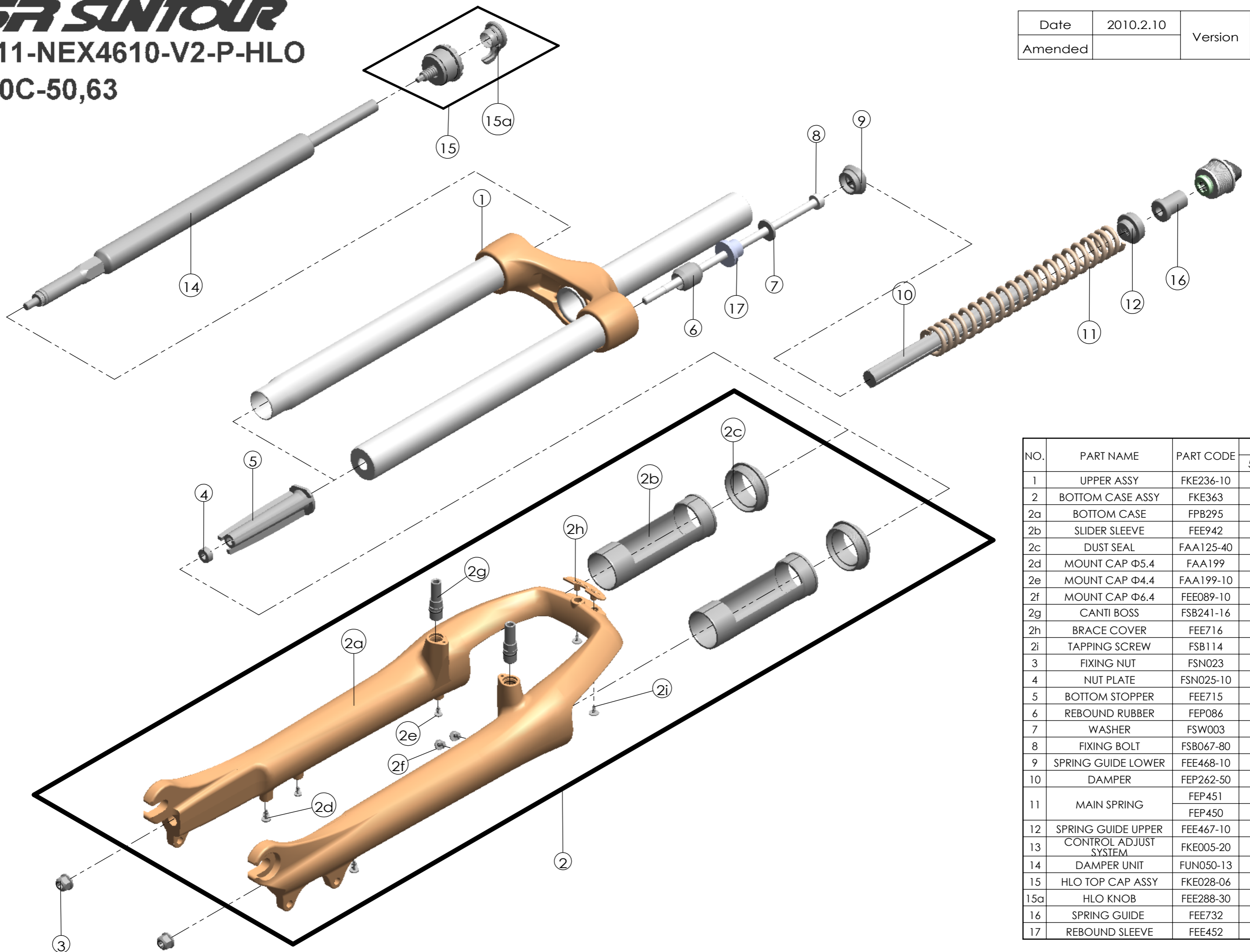

| NO. | PART NAME | PART CODE | QTY. | |
|-----|-----------------------|-----------|------|----|
| | | | 50 | 63 |
| 1 | UPPER ASSY | FKE236-10 | 1 | 1 |
| 2 | BOTTOM CASE ASSY | FKE363 | 1 | 1 |
| 2a | BOTTOM CASE | FPB295 | 1 | 1 |
| 2b | SLIDER SLEEVE | FEE942 | 2 | 2 |
| 2c | DUST SEAL | FAA125-40 | 2 | 2 |
| 2d | MOUNT CAP Φ 5.4 | FAA199 | 2 | 2 |
| 2e | MOUNT CAP Φ 4.4 | FAA199-10 | 2 | 2 |
| 2f | MOUNT CAP Φ 6.4 | FEE089-10 | 2 | 2 |
| 2g | CANTI BOSS | FSB241-16 | 2 | 2 |
| 2h | BRACE COVER | FEE716 | 1 | 1 |
| 2i | TAPPING SCREW | FSB114 | 2 | 2 |
| 3 | FIXING NUT | FSN023 | 2 | 2 |
| 4 | NUT PLATE | FSN025-10 | 1 | 1 |
| 5 | BOTTOM STOPPER | FEE715 | 1 | 1 |
| 6 | REBOUND RUBBER | FEP086 | 1 | 1 |
| 7 | WASHER | FSW003 | 1 | 1 |
| 8 | FIXING BOLT | FSB067-80 | 1 | 1 |
| 9 | SPRING GUIDE LOWER | FEE468-10 | 1 | 1 |
| 10 | DAMPER | FEP262-50 | 1 | 1 |
| 11 | MAIN SPRING | FEP451 | 1 | - |
| | | FEP450 | - | 1 |
| 12 | SPRING GUIDE UPPER | FEE467-10 | 1 | 1 |
| 13 | CONTROL ADJUST SYSTEM | FKE005-20 | 1 | 1 |
| 14 | DAMPER UNIT | FUN050-13 | 1 | 1 |
| 15 | HLO TOP CAP ASSY | FKE028-06 | 1 | 1 |
| 15a | HLO KNOB | FEE288-30 | 1 | 1 |
| 16 | SPRING GUIDE | FEE732 | 1 | 1 |
| 17 | REBOUND SLEEVE | FEE452 | 1 | - |