

Date	2012.4.14	Version	1
Amended			

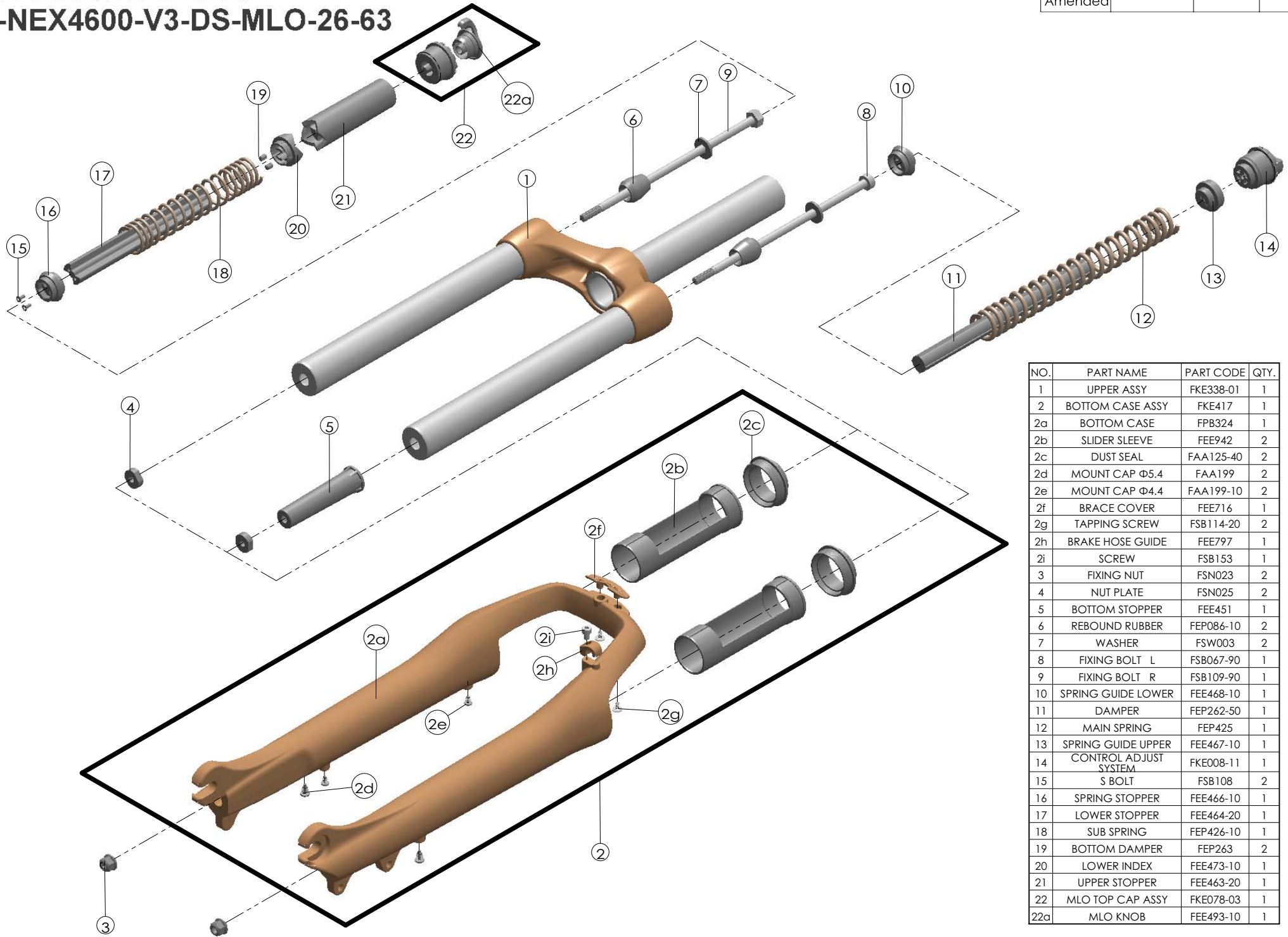

NO.	PART NAME	PART CODE	QTY.
1	UPPER ASSY	FKE338-01	1
2	BOTTOM CASE ASSY	FKE417	1
2a	BOTTOM CASE	FPB324	1
2b	SLIDER SLEEVE	FEE942	2
2c	DUST SEAL	FAA125-40	2
2d	MOUNT CAP $\Phi 5.4$	FAA199	2
2e	MOUNT CAP $\Phi 4.4$	FAA199-10	2
2f	BRACE COVER	FEE716	1
2g	TAPPING SCREW	FSB114-20	2
2h	BRAKE HOSE GUIDE	FEE797	1
2i	SCREW	FSB153	1
3	FIXING NUT	FSN023	2
4	NUT PLATE	FSN025	2
5	BOTTOM STOPPER	FEE451	1
6	REBOUND RUBBER	FEP086-10	2
7	WASHER	FSW003	2
8	FIXING BOLT L	FSB067-90	1
9	FIXING BOLT R	FSB109-90	1
10	SPRING GUIDE LOWER	FEE468-10	1
11	DAMPER	FEP262-50	1
12	MAIN SPRING	FEP425	1
13	SPRING GUIDE UPPER	FEE467-10	1
14	CONTROL ADJUST SYSTEM	FKE008-11	1
15	S BOLT	FSB108	2
16	SPRING STOPPER	FEE466-10	1
17	LOWER STOPPER	FEE464-20	1
18	SUB SPRING	FEP426-10	1
19	BOTTOM DAMPER	FEP263	2
20	LOWER INDEX	FEE473-10	1
21	UPPER STOPPER	FEE463-20	1
22	MLO TOP CAP ASSY	FKE078-03	1
22a	MLO KNOB	FEE493-10	1