

Date	2012.4.14	Version	1
Amended			

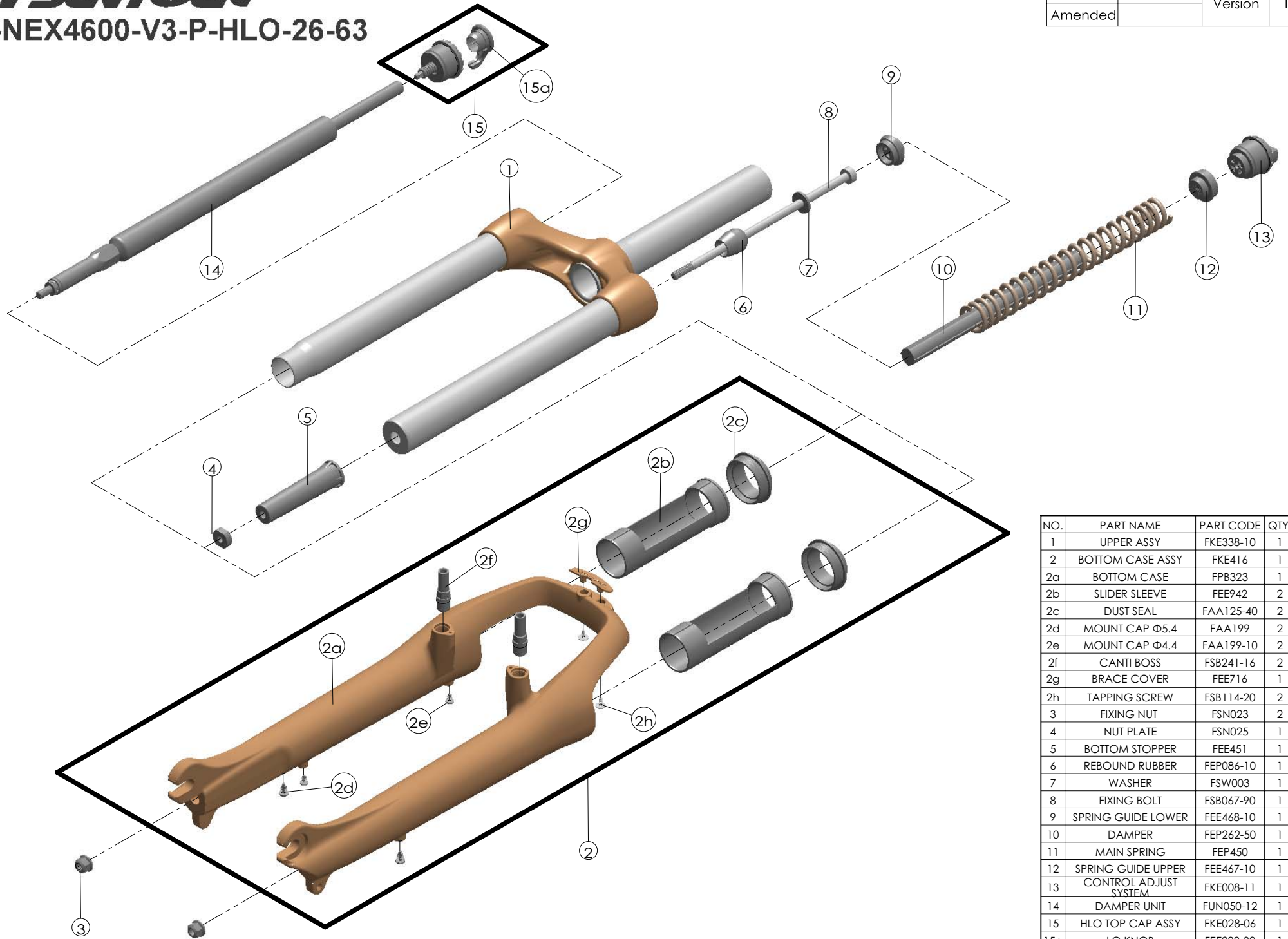

NO.	PART NAME	PART CODE	QTY.
1	UPPER ASSY	FKE338-10	1
2	BOTTOM CASE ASSY	FKE416	1
2a	BOTTOM CASE	FPB323	1
2b	SLIDER SLEEVE	FEE942	2
2c	DUST SEAL	FAA125-40	2
2d	MOUNT CAP $\Phi 5.4$	FAA199	2
2e	MOUNT CAP $\Phi 4.4$	FAA199-10	2
2f	CANTI BOSS	FSB241-16	2
2g	BRACE COVER	FEE716	1
2h	TAPPING SCREW	FSB114-20	2
3	FIXING NUT	FSN023	2
4	NUT PLATE	FSN025	1
5	BOTTOM STOPPER	FEE451	1
6	REBOUND RUBBER	FEP086-10	1
7	WASHER	FSW003	1
8	FIXING BOLT	FSB067-90	1
9	SPRING GUIDE LOWER	FEE468-10	1
10	DAMPER	FEP262-50	1
11	MAIN SPRING	FEP450	1
12	SPRING GUIDE UPPER	FEE467-10	1
13	CONTROL ADJUST SYSTEM	FKE008-11	1
14	DAMPER UNIT	FUN050-12	1
15	HLO TOP CAP ASSY	FKE028-06	1
15a	LO KNOB	FEE288-30	1