

Date	2012.4.14	Version	1
Amended			

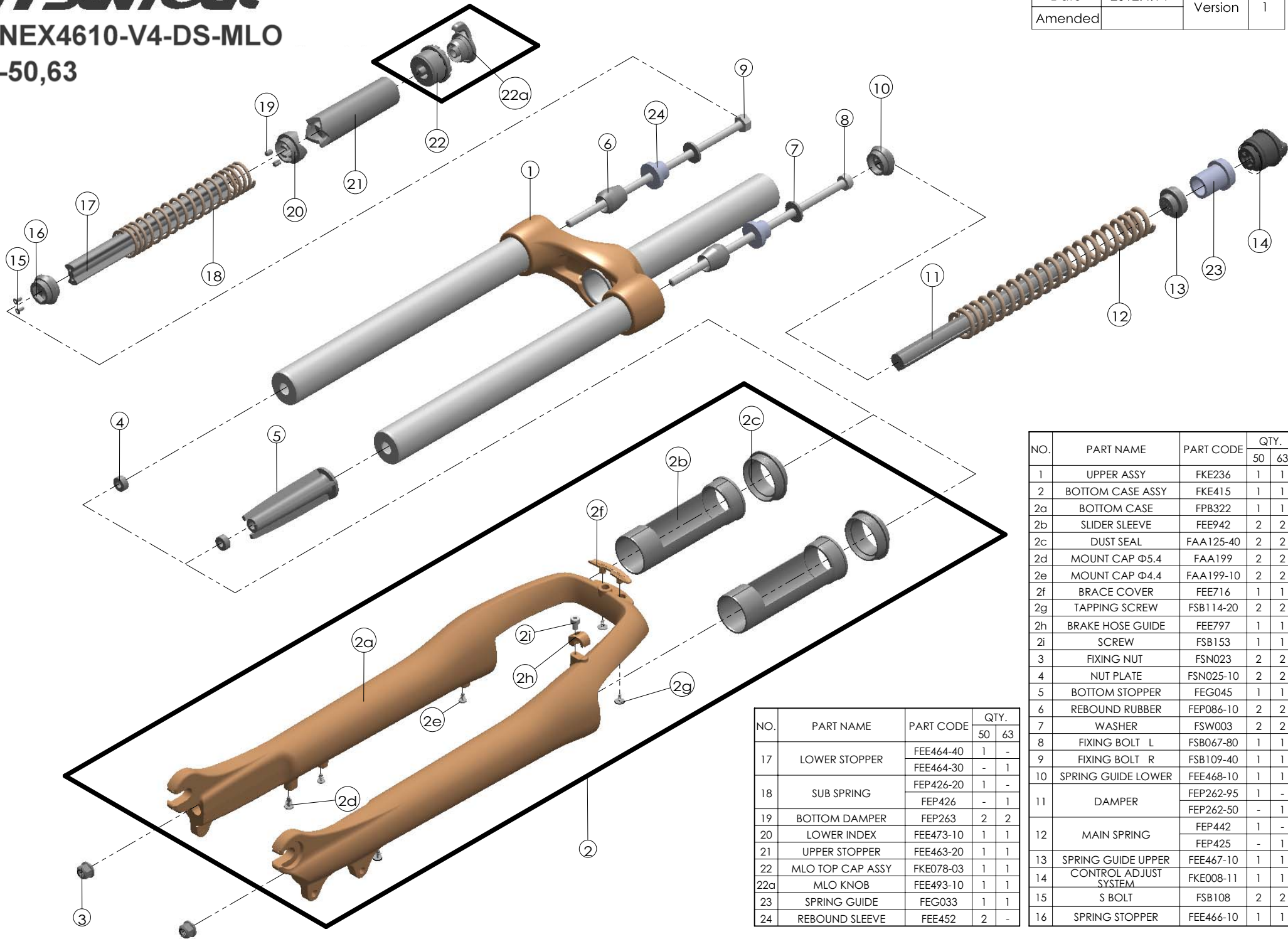

NO.	PART NAME	PART CODE	QTY.	
			50	63
1	UPPER ASSY	FKE236	1	1
2	BOTTOM CASE ASSY	FKE415	1	1
2a	BOTTOM CASE	FPB322	1	1
2b	SLIDER SLEEVE	FEE942	2	2
2c	DUST SEAL	FAA125-40	2	2
2d	MOUNT CAP Ø5.4	FAA199	2	2
2e	MOUNT CAP Ø4.4	FAA199-10	2	2
2f	BRACE COVER	FEE716	1	1
2g	TAPPING SCREW	FSB114-20	2	2
2h	BRAKE HOSE GUIDE	FEE797	1	1
2i	SCREW	FSB153	1	1
3	FIXING NUT	FSN023	2	2
4	NUT PLATE	FSN025-10	2	2
5	BOTTOM STOPPER	FEG045	1	1
6	REBOUND RUBBER	FEP086-10	2	2
7	WASHER	FSW003	2	2
8	FIXING BOLT L	FSB067-80	1	1
9	FIXING BOLT R	FSB109-40	1	1
10	SPRING GUIDE LOWER	FEE468-10	1	1
11	DAMPER	FEP262-95 FEP262-50	1	-
12	MAIN SPRING	FEP442 FEP425	1	-
13	SPRING GUIDE UPPER	FEE467-10	1	1
14	CONTROL ADJUST SYSTEM	FKE008-11	1	1
15	S BOLT	FSB108	2	2
16	SPRING STOPPER	FEE466-10	1	1

NO.	PART NAME	PART CODE	QTY.	
			50	63
17	LOWER STOPPER	FEE464-40 FEE464-30	1	-
18	SUB SPRING	FEP426-20 FEP426	1	-
19	BOTTOM DAMPER	FEP263	2	2
20	LOWER INDEX	FEE473-10	1	1
21	UPPER STOPPER	FEE463-20	1	1
22	MLO TOP CAP ASSY	FKE078-03	1	1
22a	MLO KNOB	FEE493-10	1	1
23	SPRING GUIDE	FEG033	1	1
24	REBOUND SLEEVE	FEE452	2	-