

Date	2013.7.8	Version	1
Amended			

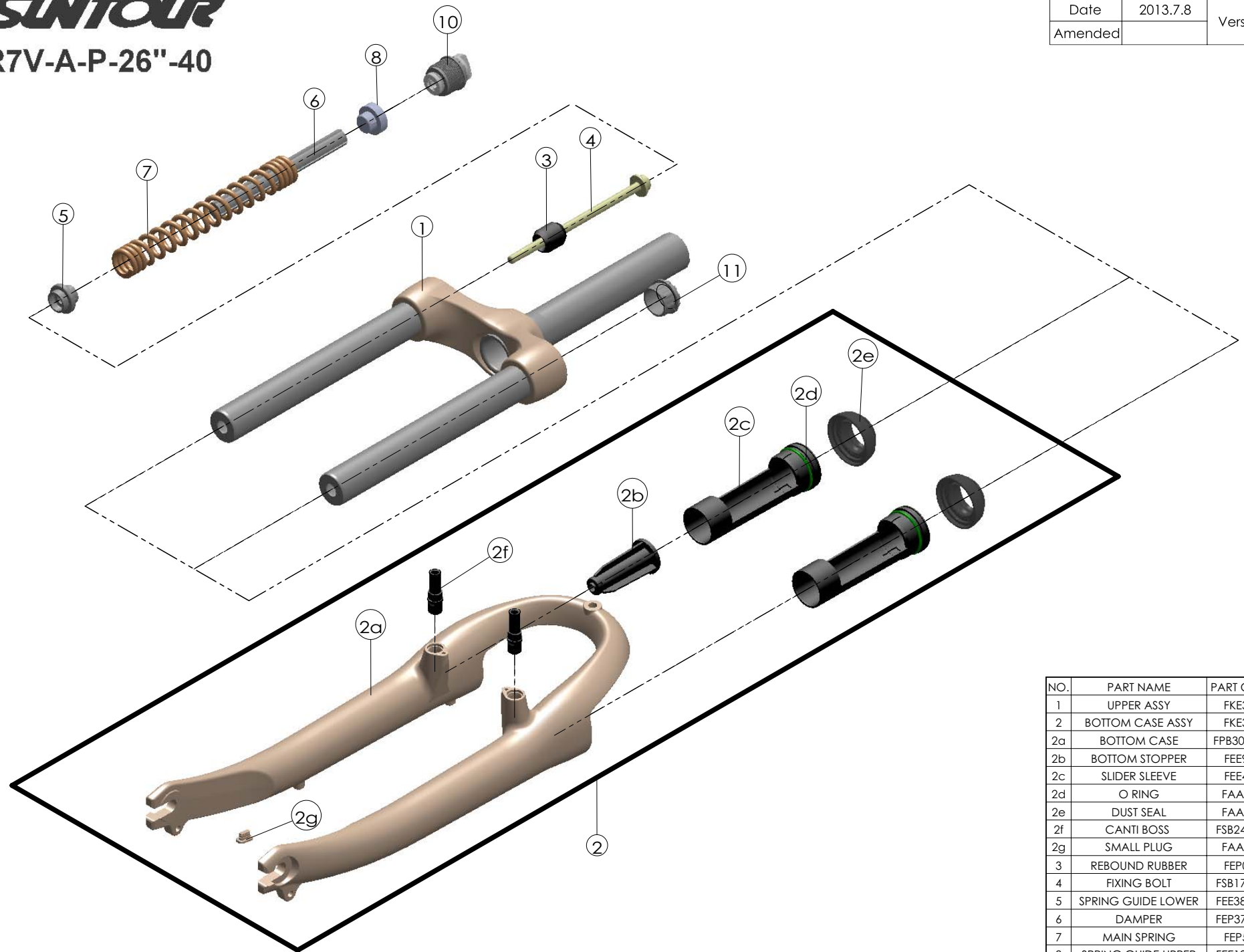

NO.	PART NAME	PART CODE	QTY.
1	UPPER ASSY	FKE392	1
2	BOTTOM CASE ASSY	FKE394	1
2a	BOTTOM CASE	FPB307-AA	1
2b	BOTTOM STOPPER	FEE987	1
2c	SLIDER SLEEVE	FEE475	2
2d	O RING	FAA188	2
2e	DUST SEAL	FAA123	2
2f	CANTI BOSS	FSB241-16	2
2g	SMALL PLUG	FAA353	1
3	REBOUND RUBBER	FEP086	1
4	FIXING BOLT	FSB171-01	1
5	SPRING GUIDE LOWER	FEE385-40	1
6	DAMPER	FEP376-10	1
7	MAIN SPRING	FEP571	1
8	SPRING GUIDE UPPER	FEE196-20	1
9	DUST SEAL	FEE514	1
10	CONTROL ADJUST SYSTEM	FKE005-10	1