

Date	2013.5.13	Version	1
Amended			

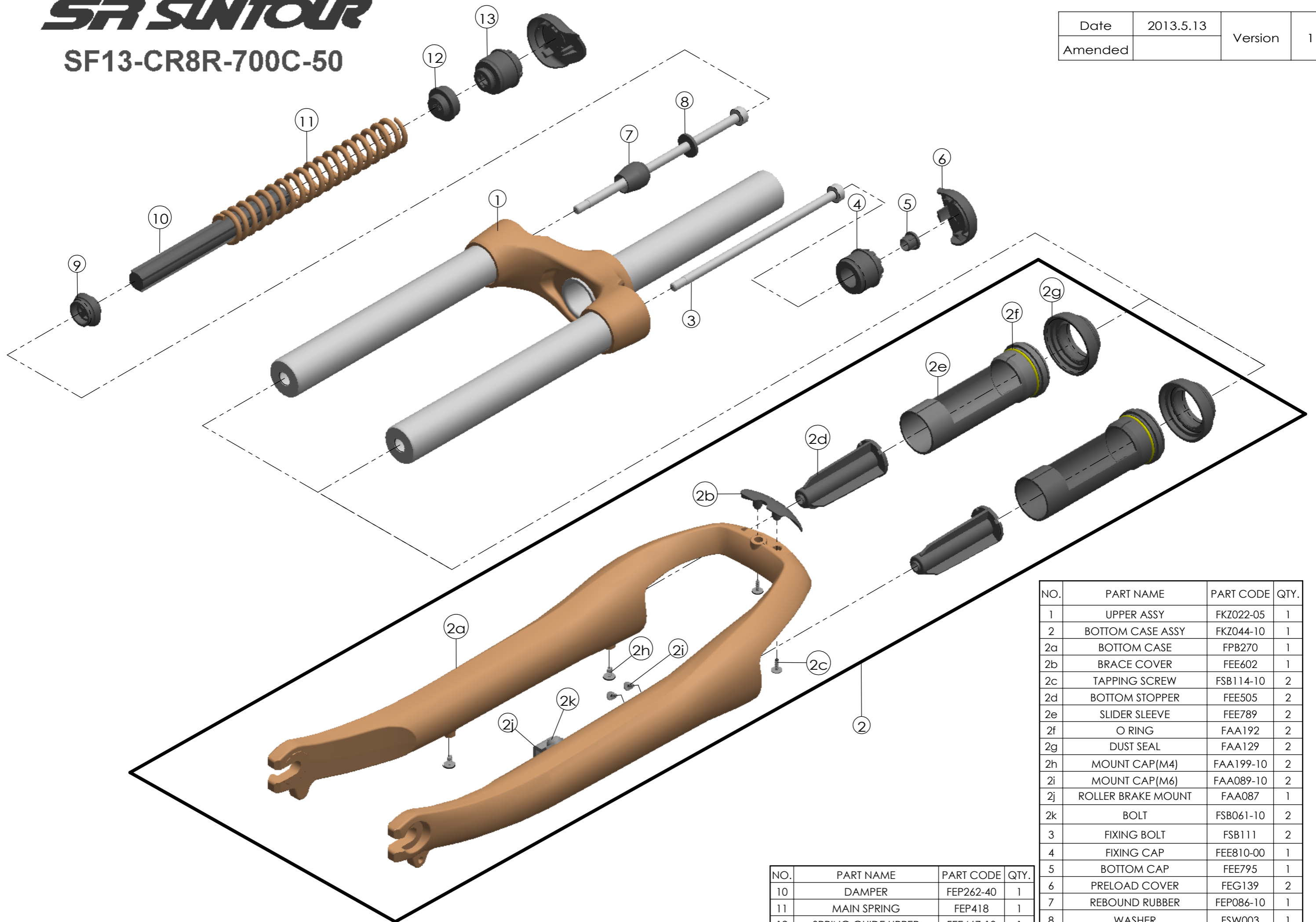

NO.	PART NAME	PART CODE	QTY.
10	DAMPER	FEP262-40	1
11	MAIN SPRING	FEP418	1
12	SPRING GUIDE UPPER	FEE467-10	1
13	CONTROL	FKE213-00	1

NO.	PART NAME	PART CODE	QTY.
1	UPPER ASSY	FKZ022-05	1
2	BOTTOM CASE ASSY	FKZ044-10	1
2a	BOTTOM CASE	FPB270	1
2b	BRACE COVER	FEE602	1
2c	TAPPING SCREW	FSB114-10	2
2d	BOTTOM STOPPER	FEE505	2
2e	SLIDER SLEEVE	FEE789	2
2f	O RING	FAA192	2
2g	DUST SEAL	FAA129	2
2h	MOUNT CAP(M4)	FAA199-10	2
2i	MOUNT CAP(M6)	FAA089-10	2
2j	ROLLER BRAKE MOUNT	FAA087	1
2k	BOLT	FSB061-10	2
3	FIXING BOLT	FSB111	2
4	FIXING CAP	FEE810-00	1
5	BOTTOM CAP	FEE795	1
6	PRELOAD COVER	FEG139	2
7	REBOUND RUBBER	FEP086-10	1
8	WASHER	FSW003	1
9	SPRING GUIDE LOWER	FEE468-10	1