

Date	2013.5.13	Version	1
Amended			

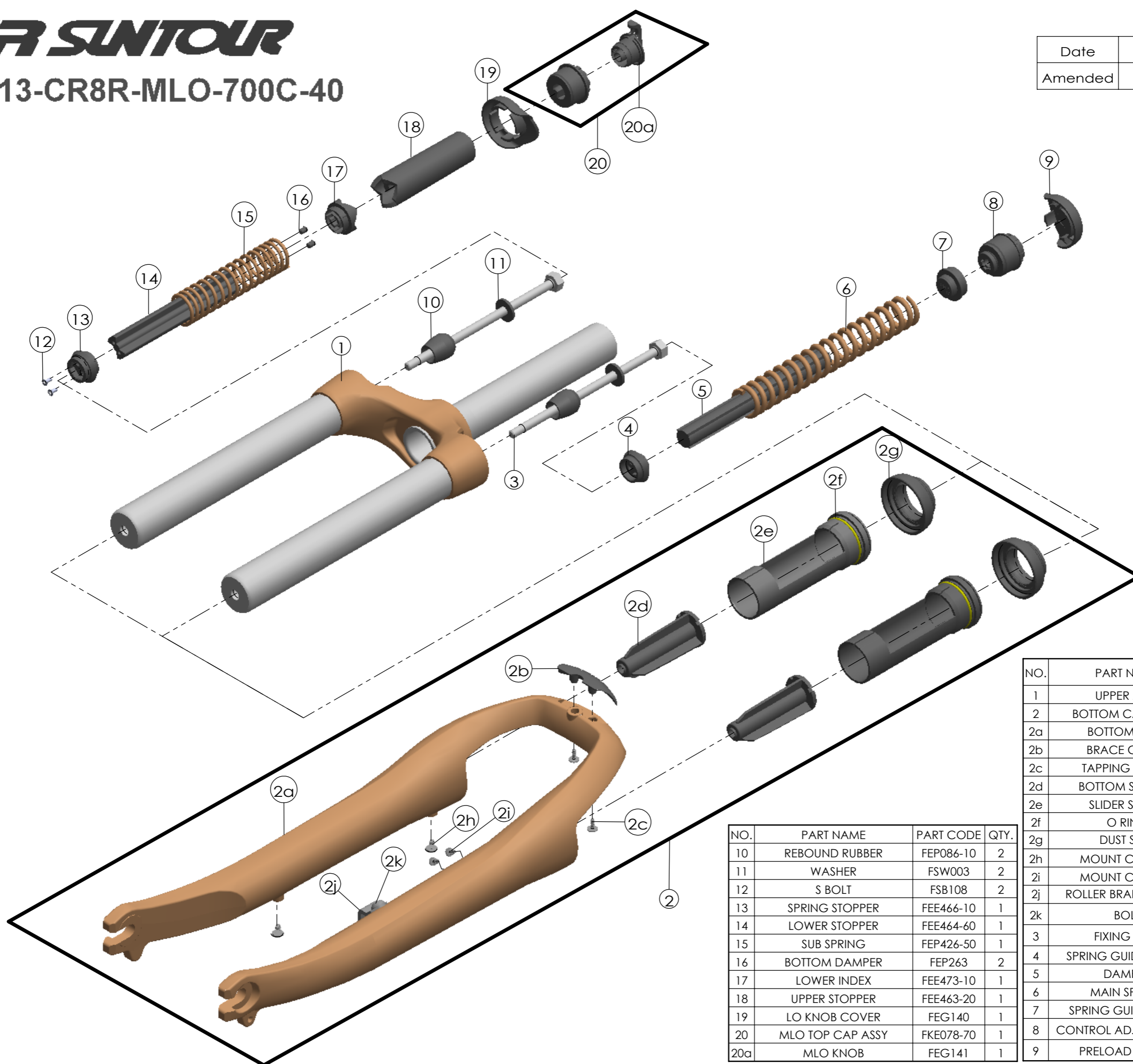

NO.	PART NAME	PART CODE	QTY.
10	REBOUND RUBBER	FEP086-10	2
11	WASHER	FSW003	2
12	S BOLT	FSB108	2
13	SPRING STOPPER	FEE466-10	1
14	LOWER STOPPER	FEE464-60	1
15	SUB SPRING	FEP426-50	1
16	BOTTOM DAMPER	FEP263	2
17	LOWER INDEX	FEE473-10	1
18	UPPER STOPPER	FEE463-20	1
19	LO KNOB COVER	FEG140	1
20	MLO TOP CAP ASSY	FKE078-70	1
20a	MLO KNOB	FEG141	1

NO.	PART NAME	PART CODE	QTY.
1	UPPER ASSY	FKZ022-06	1
2	BOTTOM CASE ASSY	FKZ044-10	1
2a	BOTTOM CASE	FPB270	1
2b	BRACE COVER	FEE602	1
2c	TAPPING SCREW	FSB114-10	2
2d	BOTTOM STOPPER	FEE505	2
2e	SLIDER SLEEVE	FEE789	2
2f	O RING	FAA192	2
2g	DUST SEAL	FAA129	2
2h	MOUNT CAP(M4)	FAA199-10	2
2i	MOUNT CAP(M6)	FAA089-10	2
2j	ROLLER BRAKE MOUNT	FAA087	1
2k	BOLT	FSB061-10	2
3	FIXING BOLT	FSB109-30	2
4	SPRING GUIDE LOWER	FEE468-10	1
5	DAMPER	FEP262-40	1
6	MAIN SPRING	FEP494	1
7	SPRING GUIDE UPPER	FEE467-10	1
8	CONTROL ADJUST SYSTEM	FKE213-00	1
9	PRELOAD COVER	FEG139	1