

# SUNTOUR

SF18RUX38 boost-R2C2-PCS-  
27.5-200-QR-CTS

|         |            |         |   |
|---------|------------|---------|---|
| Date    | 2018.-4.20 | Version | 3 |
| Amended | 2019.-7.-2 |         |   |

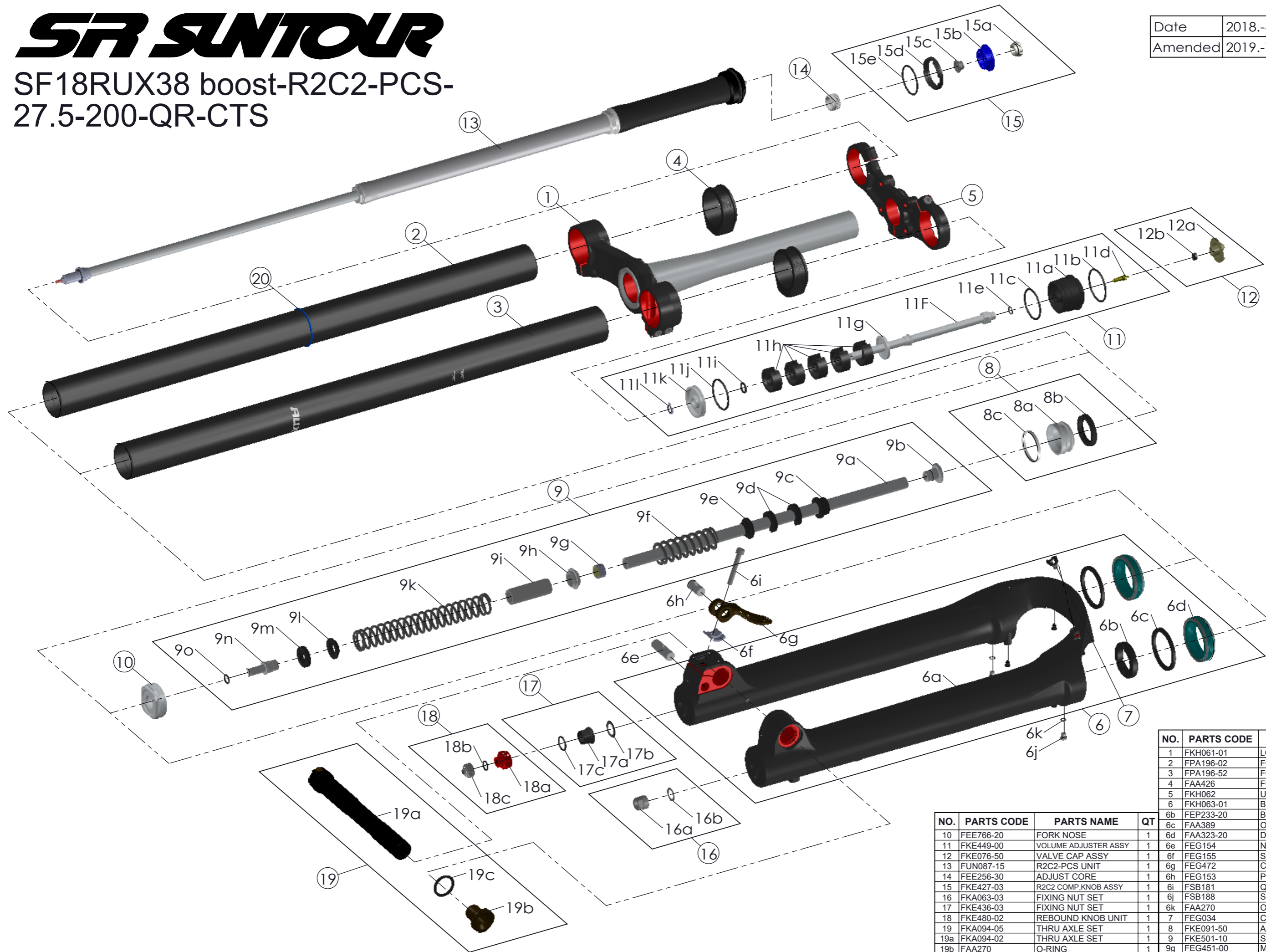

| NO. | PARTS CODE | PARTS NAME             | QT |
|-----|------------|------------------------|----|
| 1   | FKH061-01  | LOWER CROWN ASSY       | 1  |
| 2   | FPA196-02  | FORK PIPE R            | 1  |
| 3   | FPA196-52  | FORK PIPE L            | 1  |
| 4   | FAA426     | FORK BUMPER            | 2  |
| 5   | FKH062     | UPPER CROWN ASSY       | 1  |
| 6   | FKH063-01  | BOTTOM CASE ASSY       | 1  |
| 6b  | FEP233-20  | BOTTOM BUMPER          | 1  |
| 6c  | FAA389     | OIL WIPER              | 1  |
| 6d  | FAA323-20  | DUST SEAL              | 1  |
| 6e  | FEG154     | NUT                    | 1  |
| 6f  | FEG155     | SLIDER                 | 1  |
| 6g  | FEG472     | CAM LEVER              | 1  |
| 6h  | FEG153     | PIVOT                  | 1  |
| 6i  | FSB181     | QR FIXING BOLT         | 1  |
| 6j  | FSB188     | SEAL SCREW             | 1  |
| 6k  | FAA270     | O-RING                 | 1  |
| 7   | FEG034     | CABLE CLIP             | 1  |
| 8   | FKE091-50  | AIR PISTON UNIT        | 1  |
| 9   | FKE501-10  | SUPPORT TUBE ASSY      | 1  |
| 9a  | FAA270     | O-RING                 | 1  |
| 9b  | FEG451-00  | METAL BUSHING          | 1  |
| 9c  | FEG471     | AXLE BOLT              | 1  |
| 9d  | FEG095-10  | REBOUND SPRING GUIDE 2 | 1  |
| 9e  | FEP692     | REBOUND SPRING LOWER   | 1  |